



(FINAL) MEDIÇÃO: 20ª MEDIÇÃO REV01
REFERENTE AO MÊS: 01/07/21 À 17/07/21
DATA DA MEDIÇÃO: 17/07/2021

CLIENTE: PREFEITURA MUNICIPAL DE SOROCABA

OBRA: CONSTR. DE VIADUTO E READEQUAÇÃO DE ACESSOS (Trechos J.J. Lacerda x Av. Ipanema)

LOCAL: RUA J.J. LACERDA X AV. IPANEMA

MEMÓRIA DE CÁLCULO

Item	Serviços	Unid.	Quantidade
1	SERVIÇOS PRELIMINARES		
1.3	Broca, diâmetro 25cm, profundidade até 4m	m	300,00
BROCAS BARREIRA NEW JERSEY NAS RAMPAS DE ACESSO AO VIADUTO			

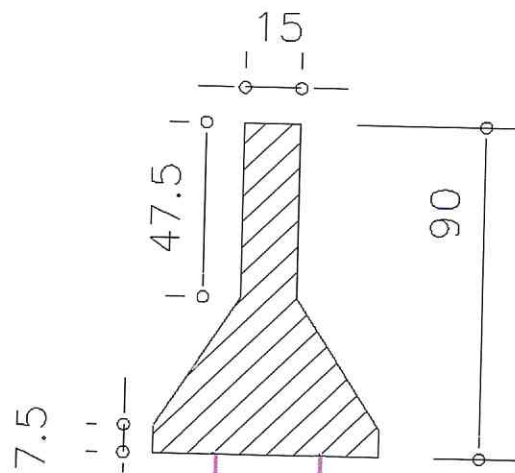

BROCA DIÂMETRO 25CM
COMPRIMENTO 0,80M

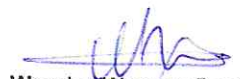
Wander Wagner Pacheco
Engenheiro Civil
CREA 5061796739

Página 1

DP BARROS PAV. E CONSTR. LTDA
Rodrigo Balle de Assis - Eng. Civil
CREA 5060917185

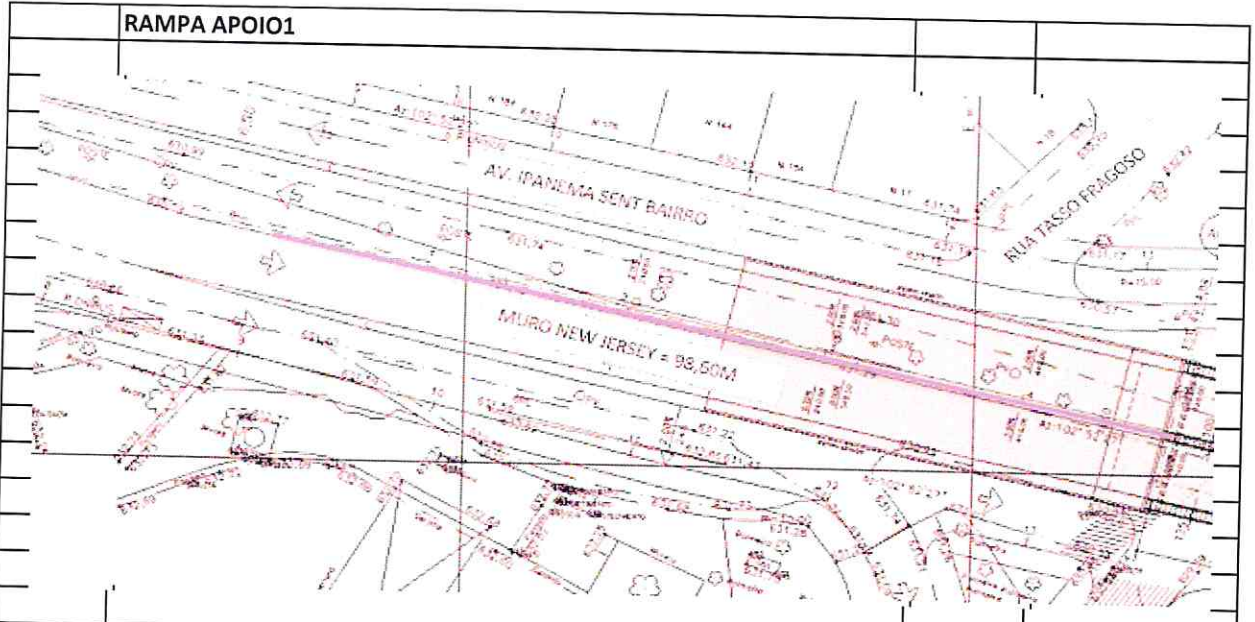

RAMPA APOIO 1
COMPRIMENTO MURO 98,60M
BROCAS A CADA 1,00M
TOTAL DE 98,00 BROCAS
COMPRIMENTO = 98 X 0,80 = 78,40M

RAMPA APOIO 6

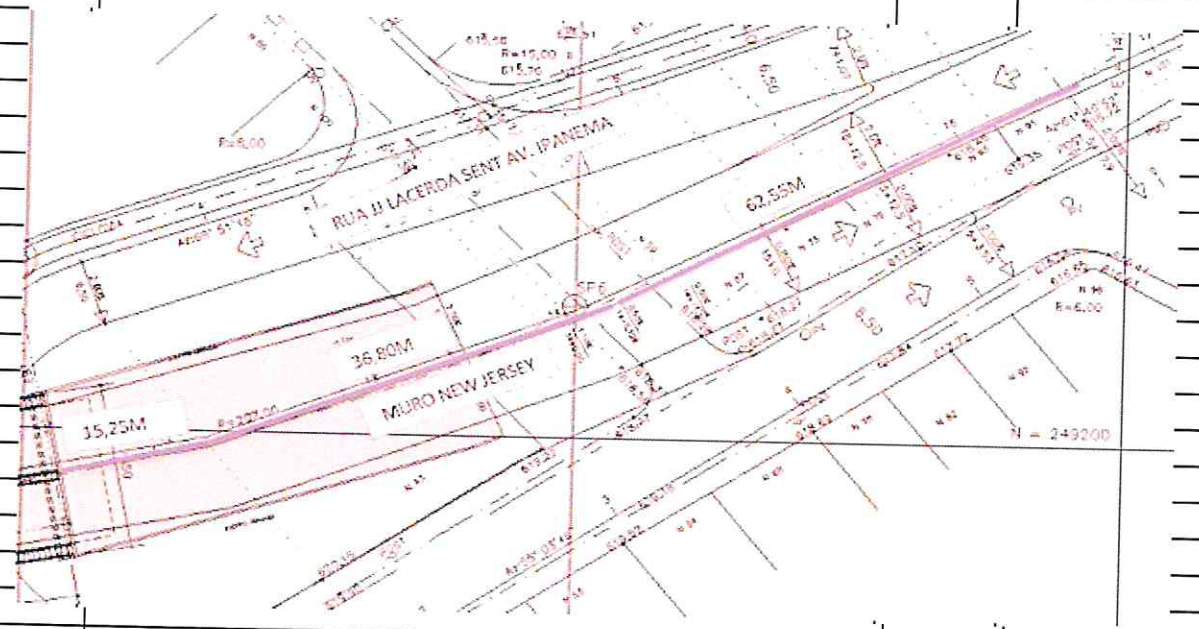

COMPRIMENTO MURO = 15,25 + 36,80 + 62,55 = 114,60M
BROCAS A CADA 1,00M
TOTAL DE 114,00 BROCAS
COMPRIMENTO = 114 X 0,80 PROF. = 91,20M

MURETA APOIO GRADIL RAMPA APOIO 1		
COMPRIMENTO MURO = 69,50 + 60,80 = 130,30M		
BROCAS A CADA 1,00M		
TOTAL DE 130 BROCAS		
COMPRIMENTO = 130 X 0,80 PROF. = 104,00M		
MURETA GRADIL APOIO 6		
COMPRIMENTO MURO = 15,25 + 18,15M = 33,40M		
BROCAS A CADA 1,00M		
TOTAL DE 33,00 BROCAS		
COMPRIMENTO = 33 X 0,80 PROF. = 26,40M		
TOTAL = 78,40 + 91,20 + 104 + 26,40 = 300,00M		

2	PAVIMENTAÇÃO		
2.1	Arrancamento de guias, inclui carga em caminhão	m	198,80

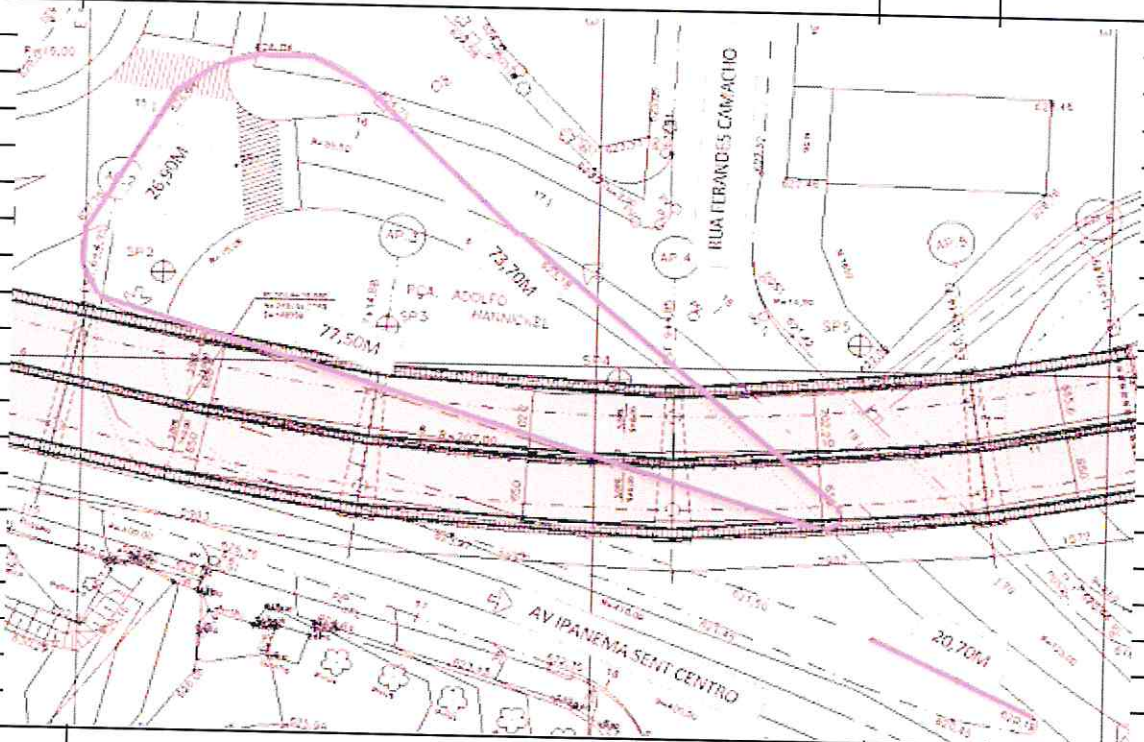

COMPRIMENTO TOTAL = 26,90 + 73,70 + 77,50 + 20,70 = 198,80

2.2	Transporte de guias	mxkm	925,52
------------	----------------------------	-------------	---------------

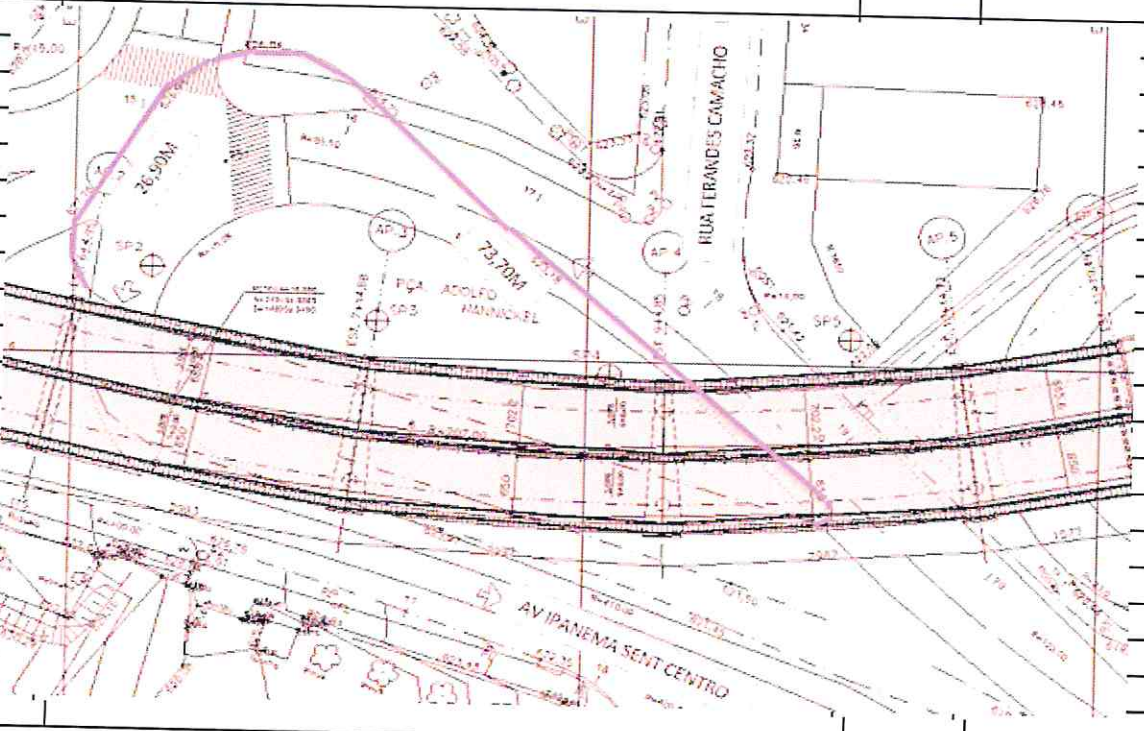

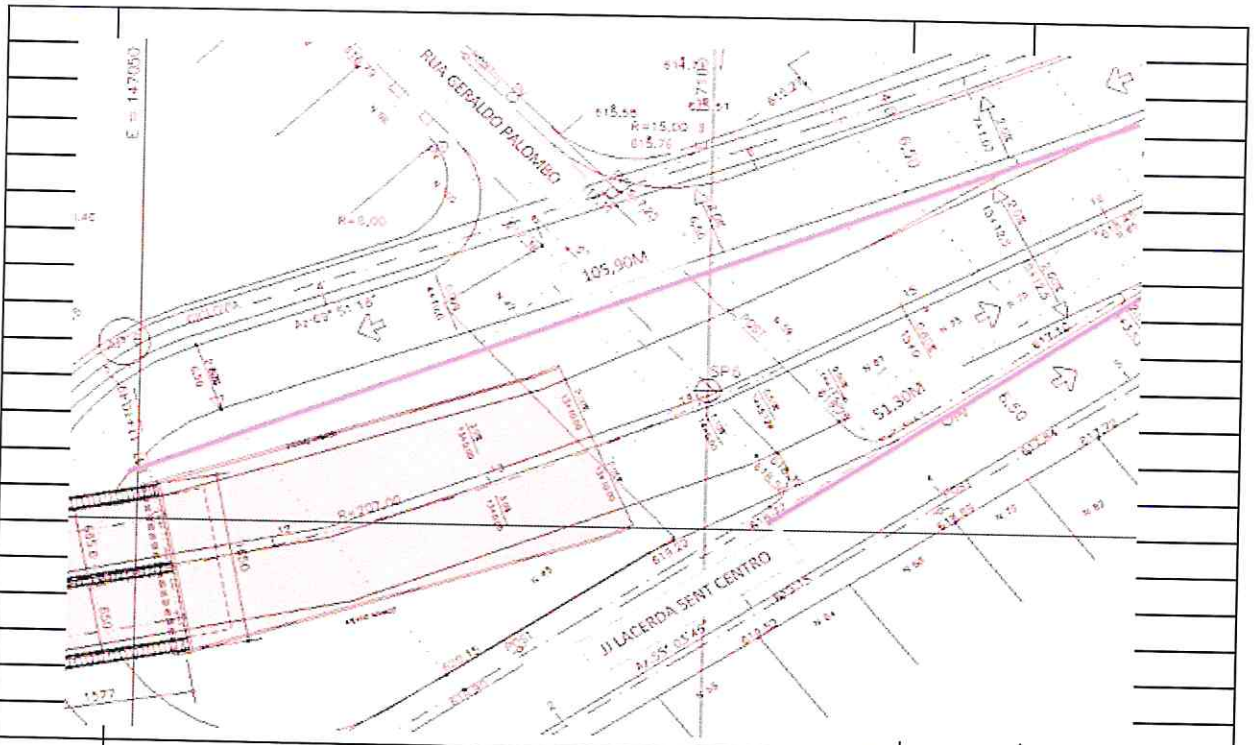

SARJETA = 0,25M

COMPRIMENTO = 105,90 + 51,30 = 157,20M

A = 157,20 X 0,25 = 39,30M²

TOTAL DE SARJETAS = 57,28 + 108,04 + 43,95 + 39,30 = 248,57M²

DEMOLIÇÃO PAV. CONCRETO (CALÇADA - PASSEIO)

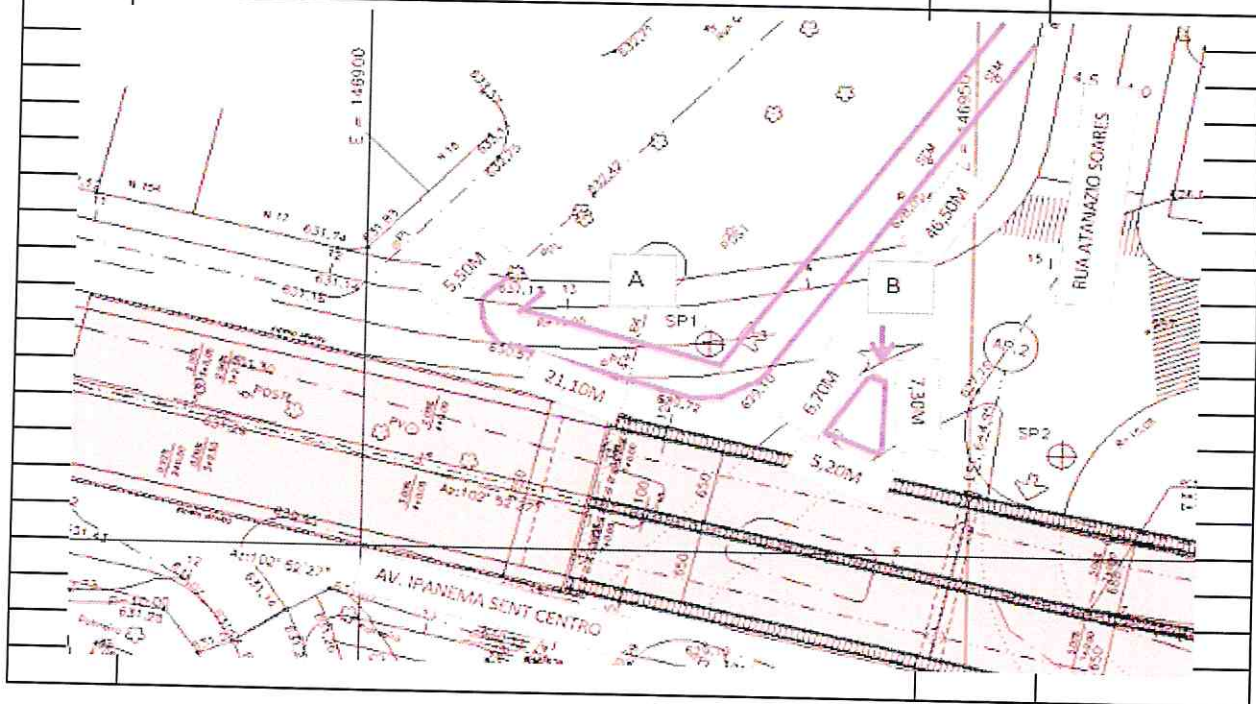

CALÇADA = 2,50M LARGURA

COMPRIMENTO A = 5,50 + 21,10 + 46,50 = 73,10M

AREA A = 73,10 X 2,50M LARG = 182,75M²

ILHA B = 5,20 X 6,70 / 2 = 17,42M²

SUB TOTAL = 182,75 + 17,42 = 200,17M²

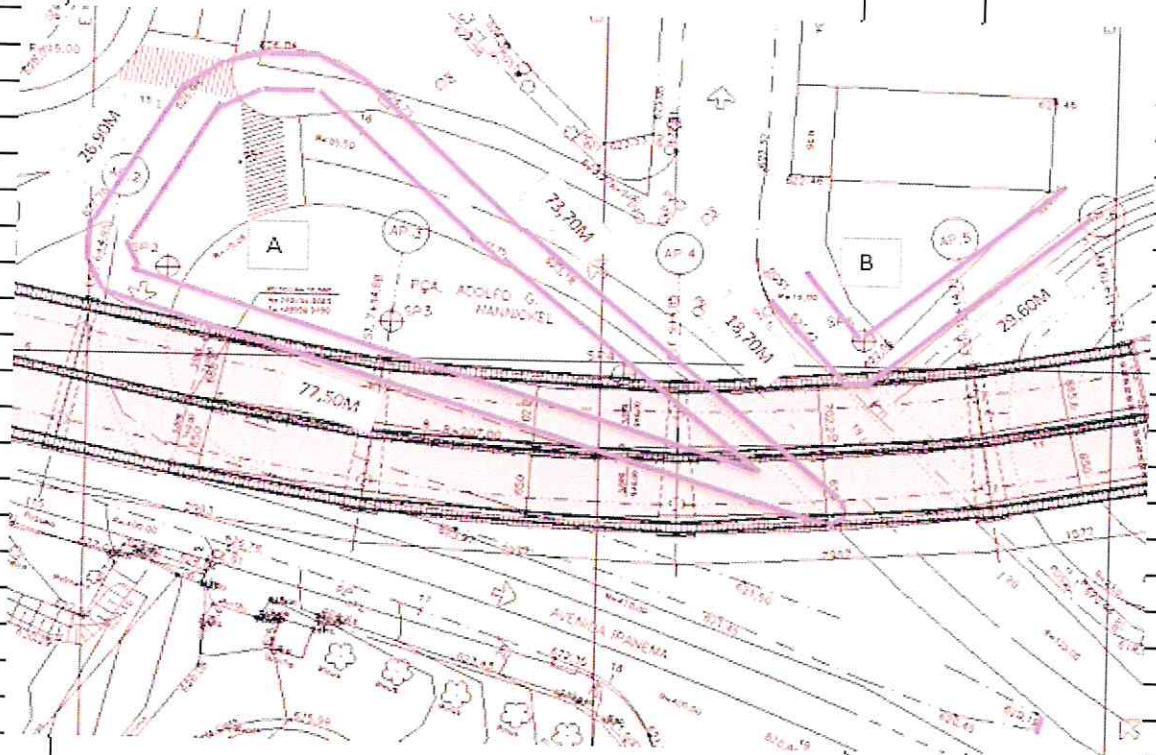

CALÇADA = 2,50M LARGURA

COMPRIMENTO A = 26,90 + 73,70 + 77,50 = 178,10M

AREA A = 178,10 X 2,50M LARG = 445,25M²

AREA B = (18,70 + 29,60) X 2,50 LARG = 120,75M²

SUB TOTAL = 445,25 + 120,75 = 466,00M²

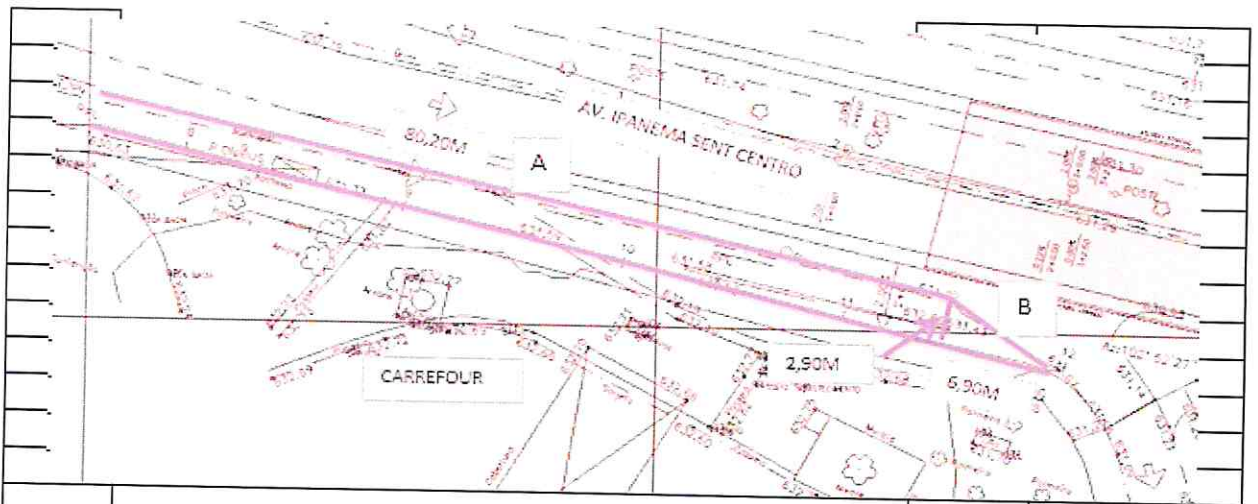

AREA A = 80,20 X 2,90 LARG = 232,58M²

AREA B = 6,90 X 2,90 / 2 = 10,00M²

SUB TOTAL = 232,58 + 10,00 = 242,58M²

CALÇADA EM FRENTE AO CARREFOUR, LOCAL DO ANTIGO BICICLETÁRIO DA URBES

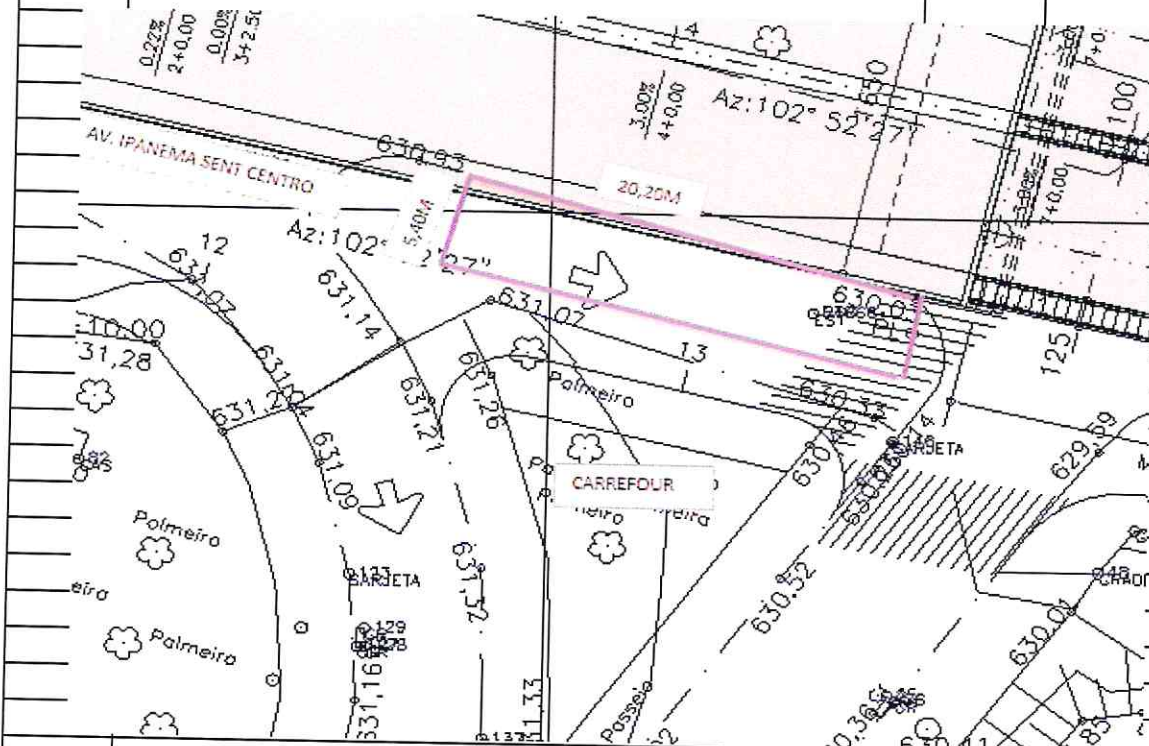

RAMPA APOIO 6

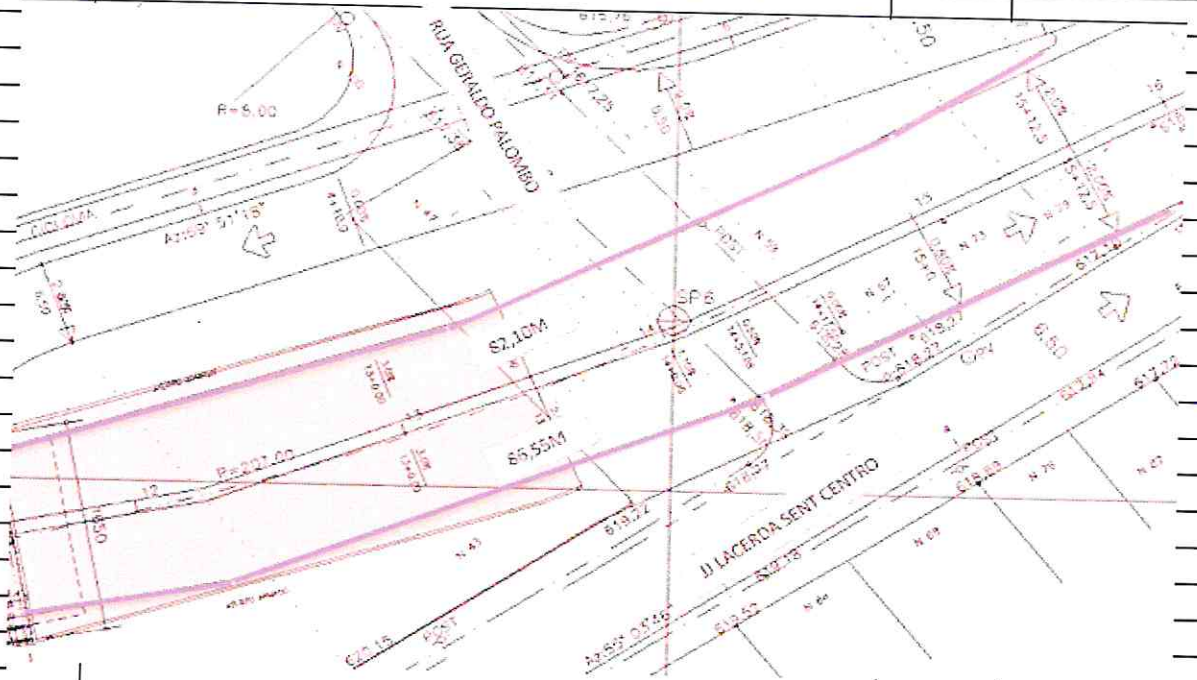

COMPRIMENTO = 82,10 + 86,55 = 168,65M

V = 0,15 ESP X 0,25 LARG X 168,65 M = 6,32M³

TOTAL = 5,03 + 6,99 + 6,32 = 18,22M³

2.9 Guia de concreto FCK 20 MPa (extrusada)

m³

19,16

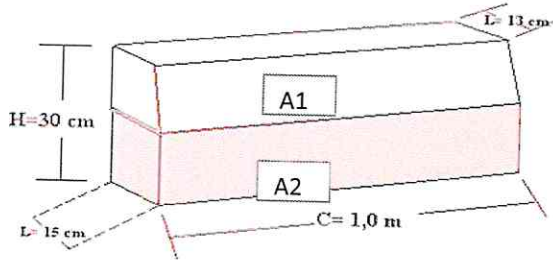

A1 = (0,15 + 0,13) X 0,15/2 = 0,021 M²

A2 = 0,15 X 0,15 = 0,023M²

AT= 0,021 + 0,023 = 0,044M²

RAMPA APOIO 6			
COMPRIMENTO = 82,10 + 86,55 = 168,65M			
$V = 0,044M^2 \times 168,65 = 7,42M^3$			
TOTAL = 4,91 + 6,83 + 7,42 = 19,16M ³			
2.14	Revestimento de concreto asfáltico (sem transporte)	m ³	89,32
$A = 94,18 \text{ COMPR} \times 6,50 \text{ LARG} = 612,17M^2$			

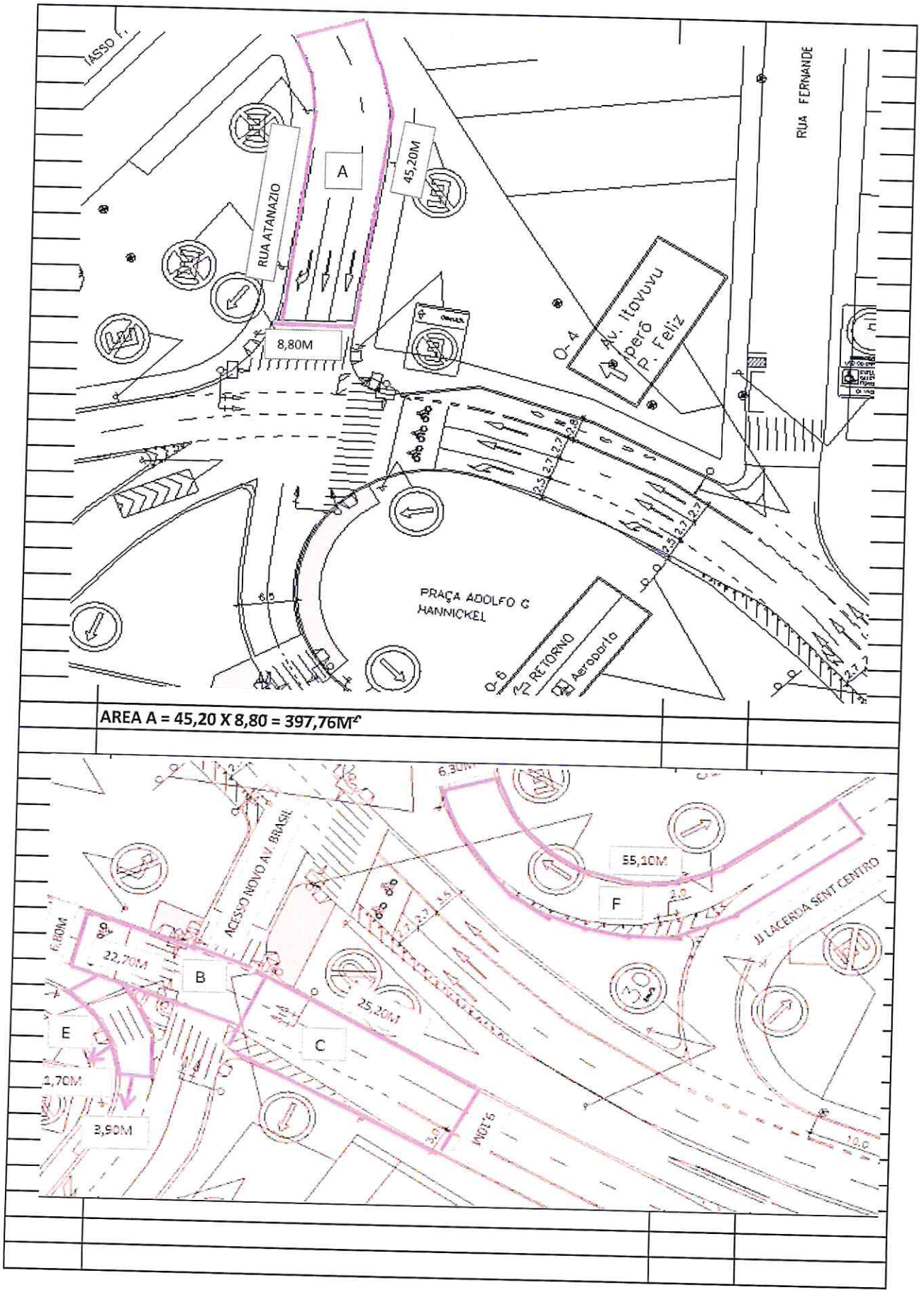

2.18	Fresagem de pavimento asfáltico com espessura até 5cm, em vias arteriais, inclusive remoção do material fresado até 10 km	m ²	305,00
$A1 = 8,01 \times 24,47 = 196,00M^2$			
$A2 = 54,50 \times 1,00 \text{ LARG} = 54,50M^2$			
$A3 = 54,50 \times 1,00 \text{ LARG} = 54,50M^2$			
$\text{ÁREA TOTAL} = 196,00 + 54,50 + 54,50 = 305,00M^2$			

2.20	Corte de concreto com disco diamantado até a profundidade de 13cm	m ²	84,26
------	---	----------------	-------

CORTE PAVIMENTO PARA IMPLANTAÇÃO RAMPA DO APOIO 1

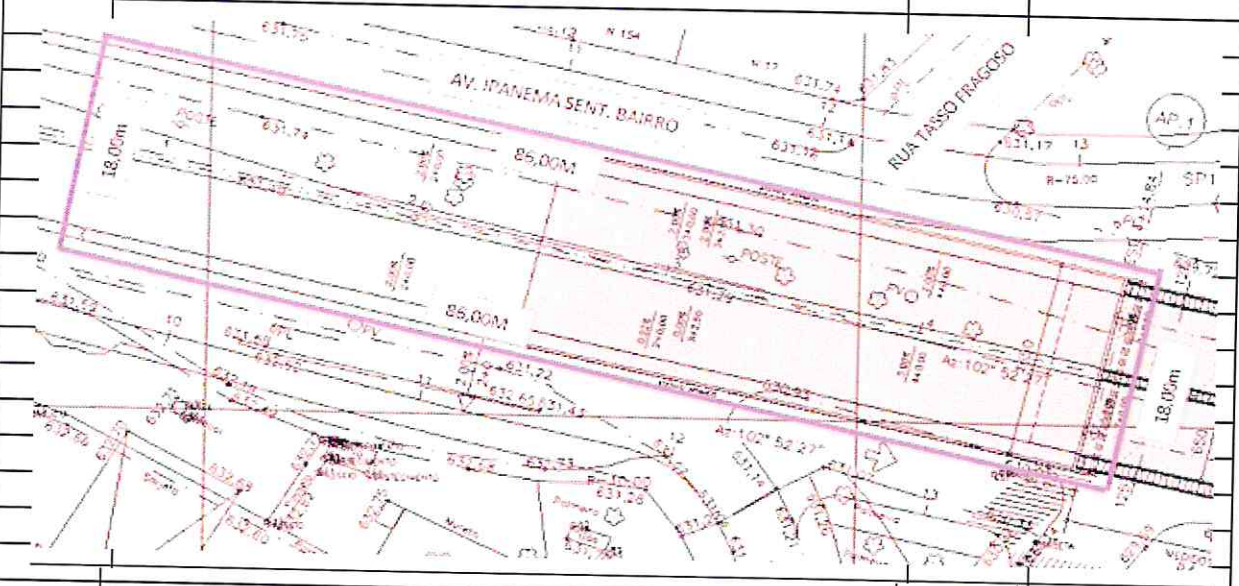

$$A = (86,00 + 86,00 + 18,00 + 18,00) \times 0,13 = 27,04\text{M}^2$$

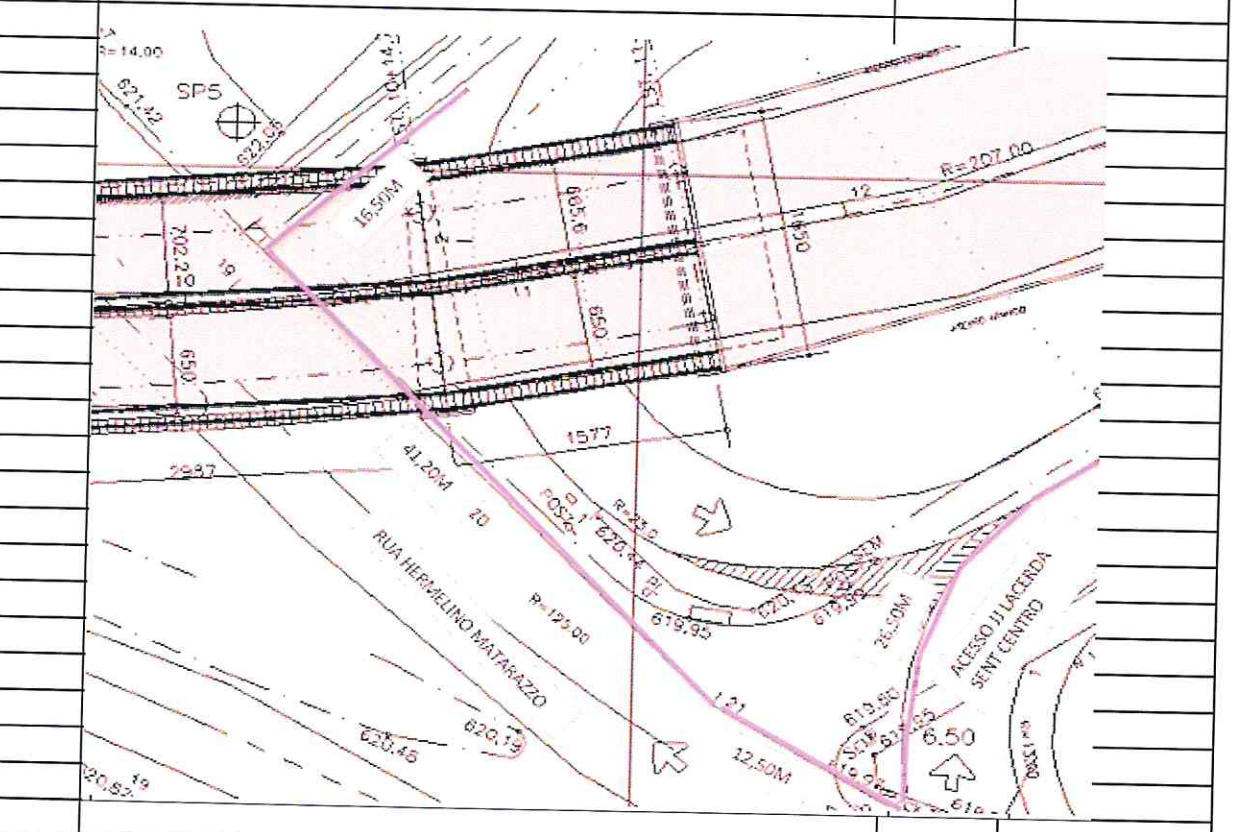

$$A = (16,50 + 41,20 + 12,50 + 26,50) \times 0,13 = 12,57\text{M}^2$$

P

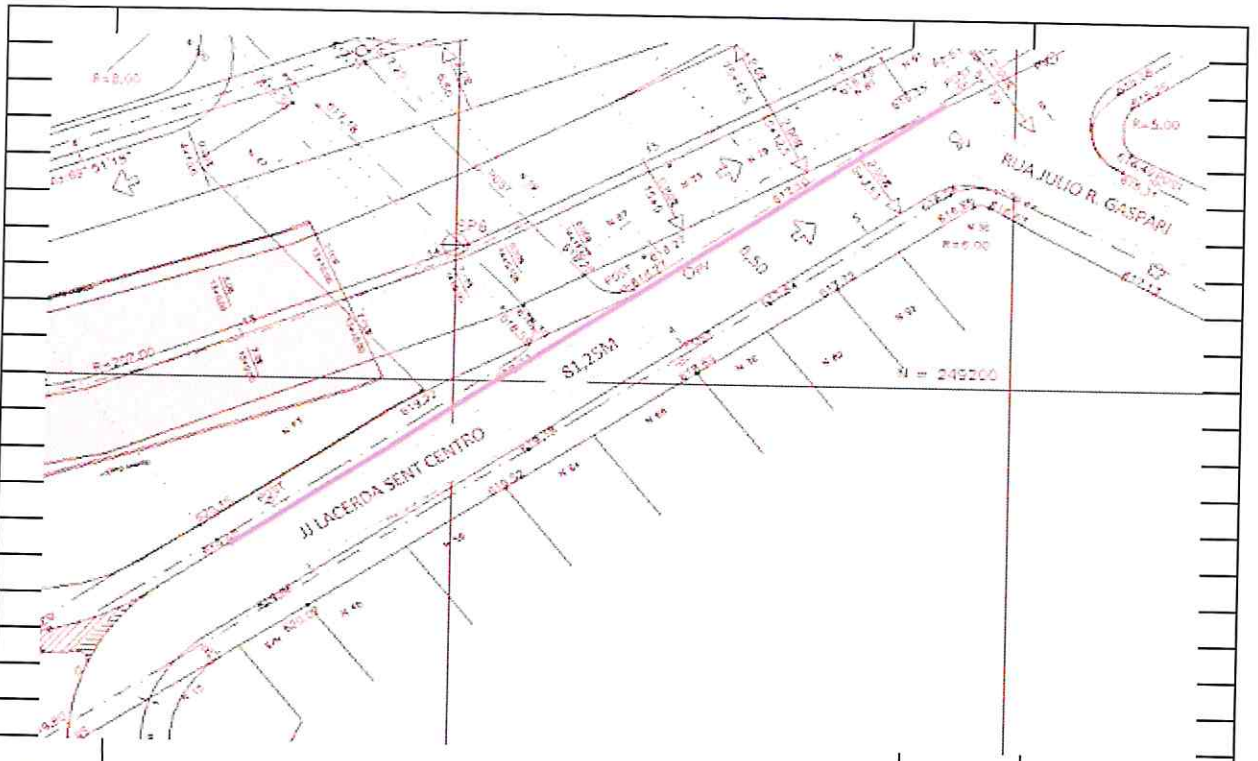

$A = 81,25M \times 0,13 = 10,56M^2$

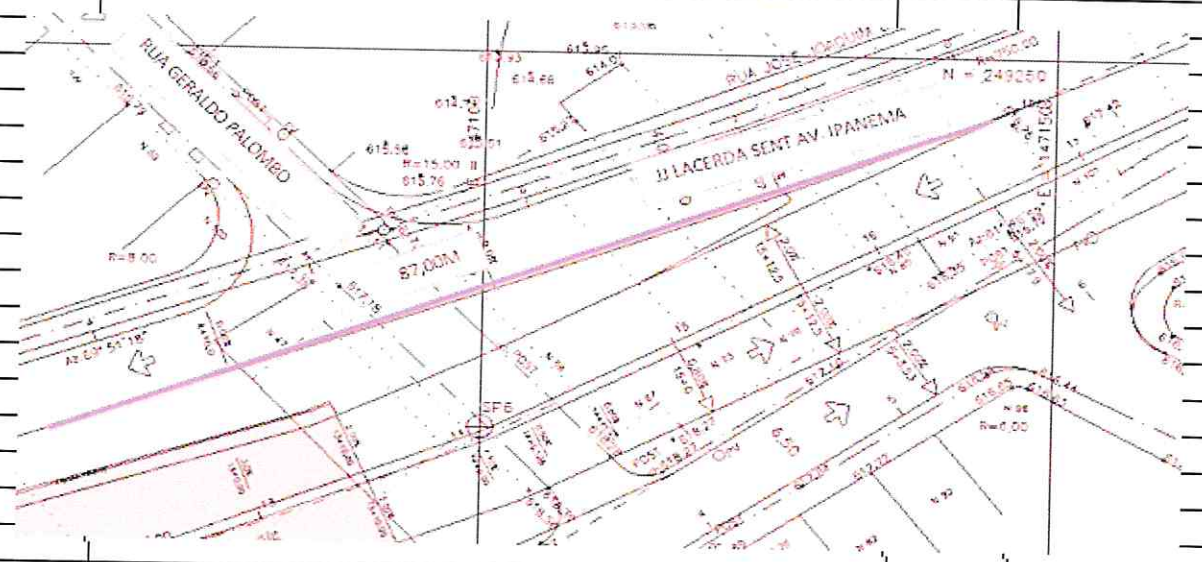

$A = 87,00 \times 0,13 = 11,31M^2$

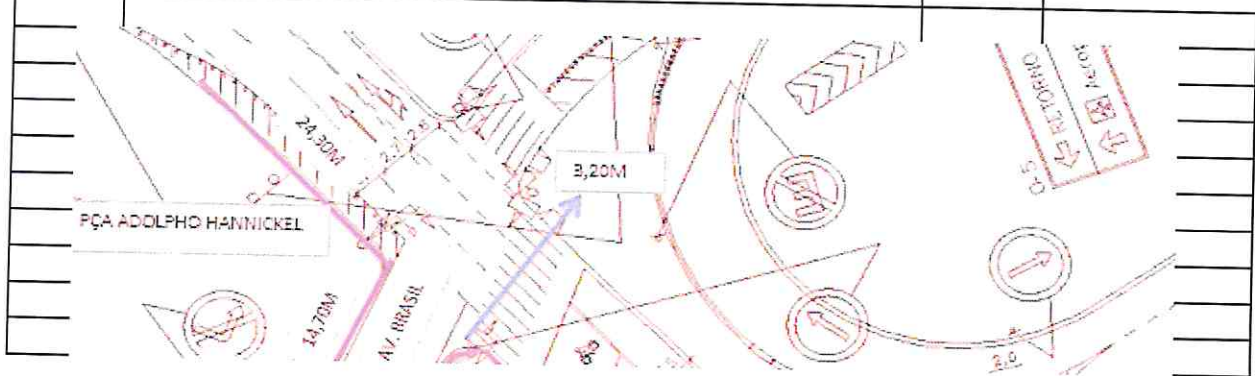

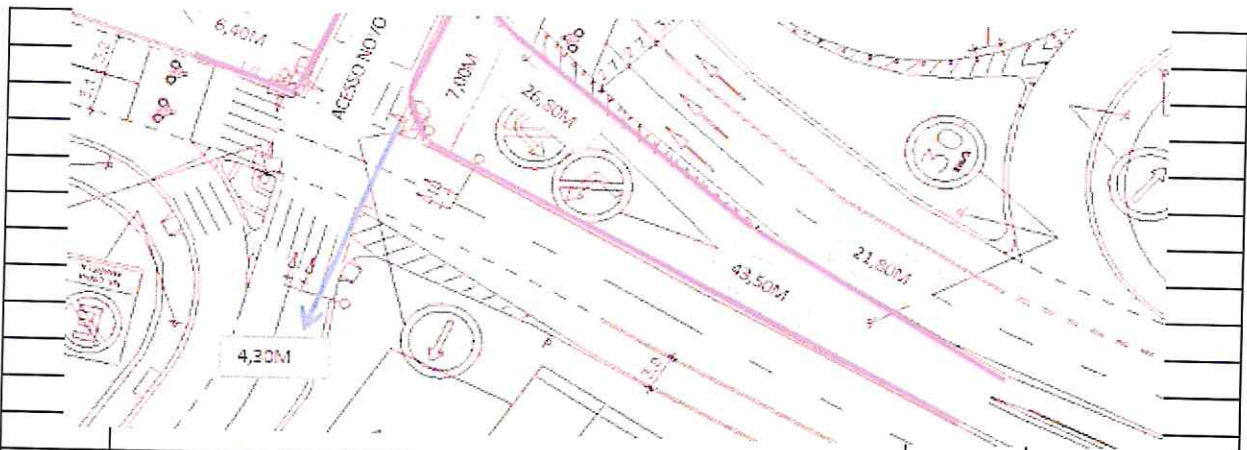

$$A = (6,40 + 14,70 + 24,30 + 43,50 + 4,30 + 7 + 3,20 + 21,80) \times 0,13$$

$$A = 16,28M^2$$

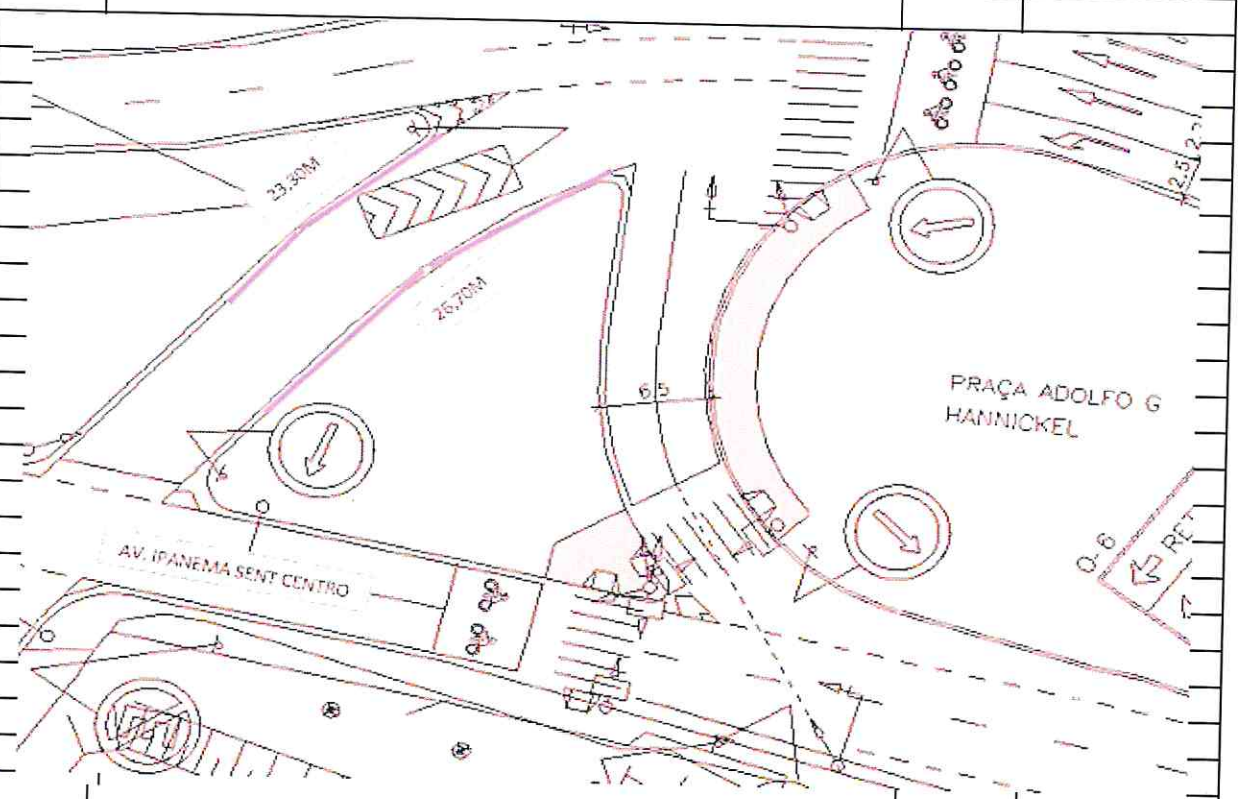

$$A = (23,30 + 26,70) \times 0,13 = 6,50M^2$$

$$A \text{ TOTAL} = 27,04 + 12,57 + 10,56 + 11,31 + 16,28 + 6,50 = 84,26M^2$$

2.23	Reforma de boca de lobo simples	unid	3,00
<p>TOTAL DE 3 REFORMAS DE BOCA DE LOBO SIMPLES</p>			